

ORAYA 1700

USER MANUAL



Empowering. Healthcare. Solutions

INTRODUCTION

COPYRIGHT

This user manual is supplied with the purchase of a bath and any optional equipment and is intended to provide information on its correct and safe use. Copying it for these purposes is only permitted if it is copied in its entirety to ensure all the pertinent health and safety related information along with the user information is retained together as a whole. Copying single or several pages for the purposes detailed above is not permitted under any circumstances © 2023.



Contact: Gainsborough Healthcare Group: Tel 01527 400022.

PREFACE

Additional reading and related information can be obtained by requesting it from Gainsborough Healthcare group Ltd. These include Circuit Diagrams, Component Parts Lists, Descriptions, Calibration Instructions, and other information that will assist service personnel.

INTENDED USE

This bath is designed to be used for general hygiene purposes as well as relaxation. The bath must not be used for any other purpose.

RECYCLING

The following materials are used in the packaging of the bath for transportation purposes. Separate the materials as recommended and dispose of in line with your local authority and at a waste disposal centre recommended by them.

- Made up of Glass Reinforced Plastic (GRP) and Wood
- Batteries and other Electrical Components as applicable
- Metal and Acrylonitrile Butadiene Styrene (ABS) plastic
- Packaging - wood, cardboard and plastics
- Glass

TRANSPORT AND STORAGE

When transporting or storing the bath and any additional equipment ensure the seat is in its lowest position, optional equipment is securely fastened to a sturdy transportation board or pallet. Failure to do so could damage the bath and other equipment and invalidate the warranty.

FUTURE PRODUCT DEVELOPMENT

Gainsborough Healthcare Group Ltd operates a policy of continuous product development and reserves the right to change specifications and designs without prior notice.

TABLE OF CONTENTS

Introduction	2
Bath and Equipment Overview	4
Specifications:	8
Dimensions:	9
Safety Information	10
Purposes of Warnings, Cautions and Notes	10
Health and Safety Warnings	10
Health and Safety Cautions	11
Health and Safety Notes	11
Labels	13
Identification Label	14
User Information	15
Remote Handset	15
Backrest Install	16
Footrest Install (Option)	17
Close the Pop-Up Waste	17
Fill the Bath	18
Transfer Bather into Bath	19
Topping Up the Bath	20
Remove Bather From the Bath	20
Empty the bath	21
Raise the Platform	22
Lock the Platform	22
Lower the Platform	23
Using the Shower	23
Optional Equipment	24
Foot Rest Option	24
Autofill Option	24
Thermostatic Twin Lever Bath Filler Option	25
Schuchmann Basti Seat Option	25
Air Spa Option	26
Air Spa and Chromatherapy Lighting Option	26
Chromatherapy Lighting Option	27
Sound System Option	28
Miscellaneous Options	28
Maintenance and Cleaning	29
Troubleshooting	32
Warranty	33
Important Safety Information	34
Declaration of Conformity	35

BATH AND EQUIPMENT OVERVIEW

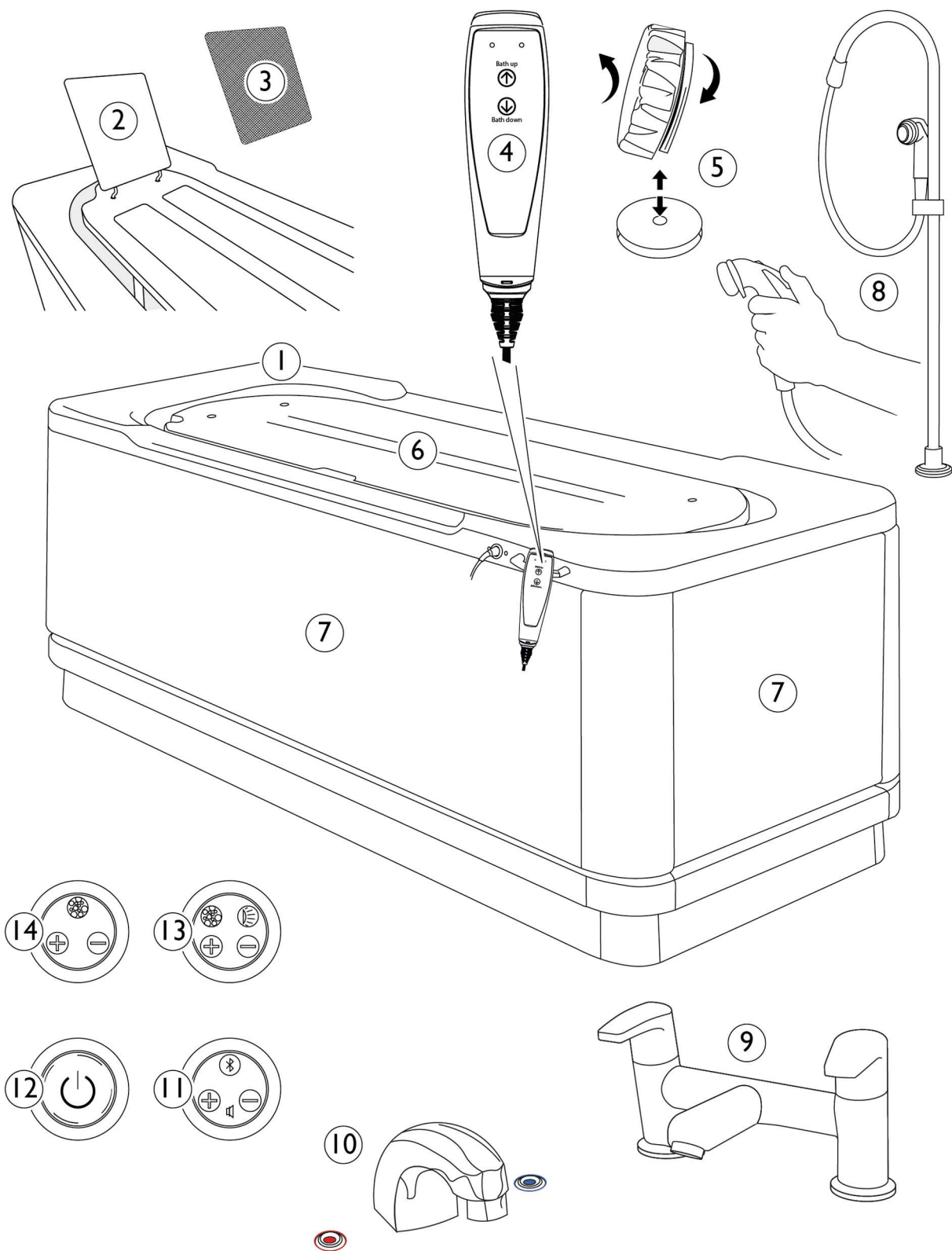

Not Drawn to Scale

Fig 0305

Key: Refer to Fig 0305

- 1 Platform bath
- 2 Backrest
- 3 Backrest cover slip-resistant
- 4 Remote handset
- 5 Pop-up waste
- 6 Platform
- 7 Bath panels
- 8 Shepherds Crook shower system
- 9 Thermostatic twin lever bath filler
- 10 Auto-fill (Optional)
- 11 Sound system compatible with smart phone and tablets (Optional)
- 12 Chromatherapy lighting (Optional)
- 13 Air spa and chromatherapy lighting (Optional)
- 14 Air spa (Optional)

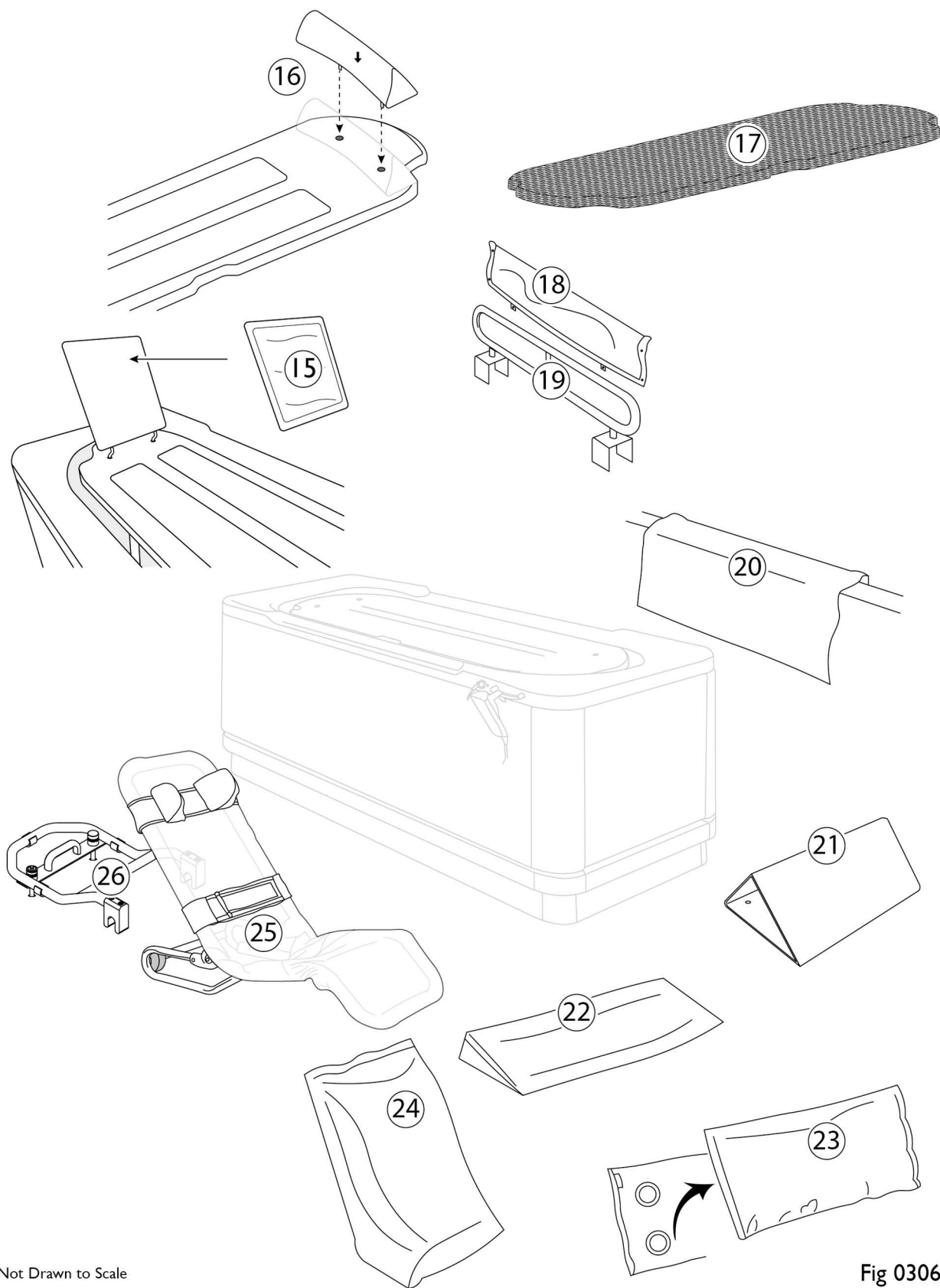



Fig 0306

Key Refer to Fig 0306

- 15 Backrest cover padded (Optional)
- 16 Footrest (Optional)
- 17 Platform cover slip-resistant (Optional)
- 18 White vinyl padded grab rail cover (Optional)
- 19 Grab rail stainless steel (Optional)
- 20 Folding utility cushion vinyl padded with suckers (Optional)
- 21 Suckered knee break with padded knee break pad (Optional)
- 22 Head wedge cushion - vinyl padded (Optional)
- 23 Mesh multi-purpose cushion with suckers (Optional)
- 25 Back rest wedge cushion - vinyl padded (Optional)
- 24 'Schuchmann Basti Seat' (Optional) use in conjunction with a 'Basti Seat Fixing Bracket' (27)
- 25 'Basti Seat Fixing Bracket' (Optional) use in conjunction with a 'Schuchmann Basti Seat' (26)

SPECIFICATIONS & DIMENSIONS

SPECIFICATIONS:

Maximum user weight: 165kg	
Water Capacity: 220ltr	
Approximate Bath weight (empty): 200kg	
Approximate Bath weight (filled): 420kg	
Bath raise 35secs	
Bath down 33secs	
Class I Electrical Device	
Power Supply: Mains 230V to be supplied via 30mA RCD	
Operating Voltage: 24V	
Battery Backup: 24V for emergency use only	
Water Supply: Unblended Hot & Cold water at 1bar Min > 5bar Max pressure	
'A' weighted sound emission: <70dB(A)	
'A' weighted sound emission with air spa system (optional extra): <75dB(A)	
Ambient temperature range: 5°C to 50°C	
Relative humidity range: 10-80%	
Atmospheric pressure range: 50kPa to 106kPa	
This bath has BioCote® technology, this has been proven to reduce bacteria and even some viruses, including influenza A H1N1, <i>E.coli</i> , <i>Salmonella</i> and MRSA	

DIMENSIONS:

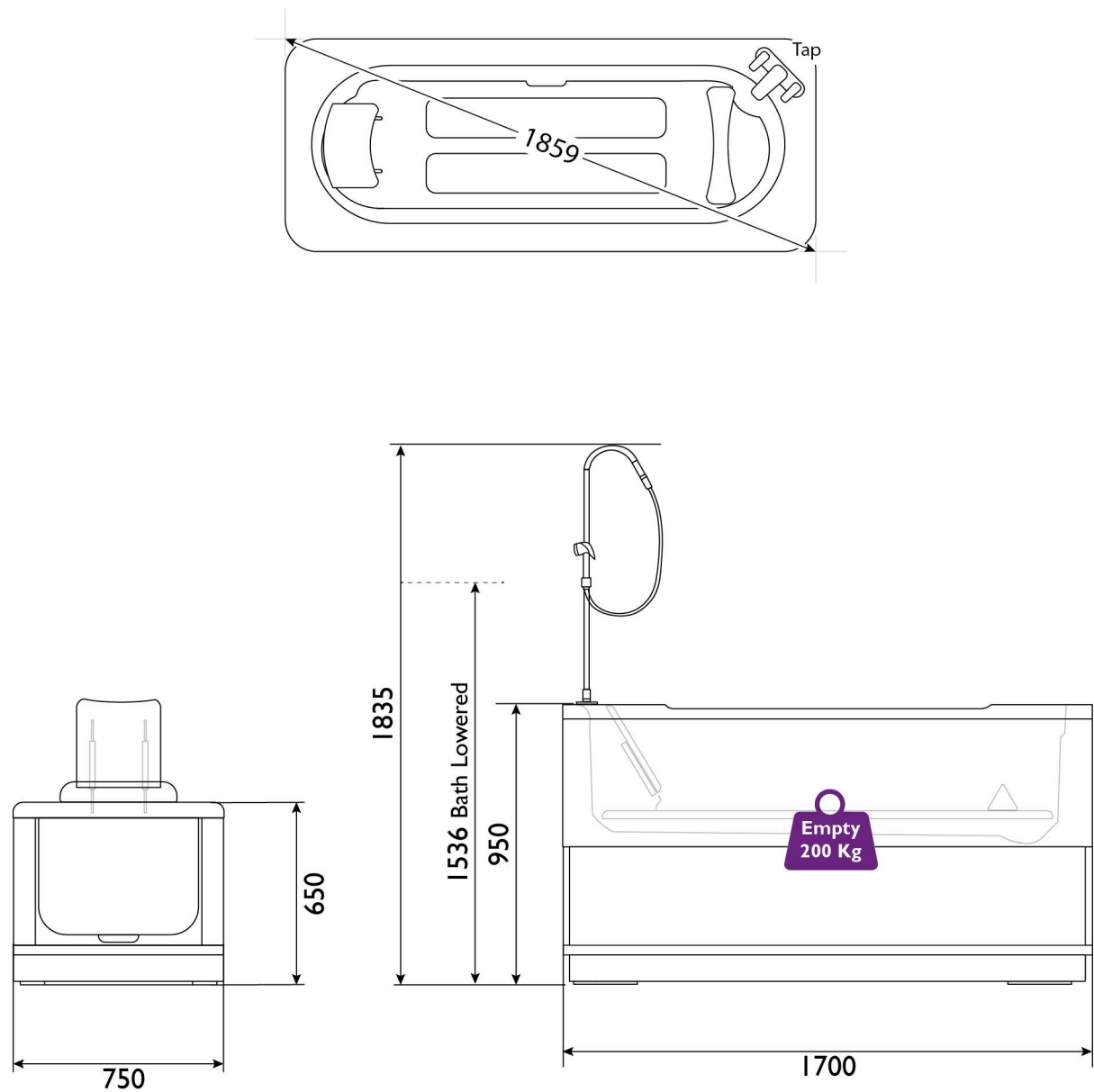

Fig 0292

Refer to Fig 0292, dimensions in millimetres (mm). Left hand example (handing of a bath is indicated by the exit point of the bath when in a seated position).

SAFETY INFORMATION

PURPOSES OF WARNINGS, CAUTIONS AND NOTES

Warnings, Cautions and notes used throughout this manual have the following meanings:



WARNINGS: Warnings used throughout this manual **MUST** be followed carefully failure to do so, could result in serious bodily injury or could be fatal.



CAUTIONS: Cautions used throughout this manual **MUST** be observed to avoid damage to your bath or additional optional equipment.



NOTES: Notes used throughout this manual contain important information and useful tips on the operation of this product.

HEALTH AND SAFETY WARNINGS

The following warnings and any additional warnings used throughout this manual **MUST** be followed carefully failure to do so, could result in serious bodily injury or could be fatal.



WARNING RISK OF ENTRAPMENT: Operating the bath without appropriate training in its safe use could cause serious injury or be fatal by entrapment. Ensure persons operating the seat have been trained, read this manual & understand its safe use.



WARNING RISK OF ENTRAPMENT: Operating the bath when persons are nearby could cause serious injury or be fatal by entrapment. Ensure **NO** persons are close to moving equipment during its operation.



WARNING RISK OF ELECTRIC SHOCK: Using electrical appliances near to the bath could cause electric shock which may be fatal. **DO NOT** use electrical appliances within 3 metres of the bath.



WARNING RISK OF ELECTRIC SHOCK: Inappropriate wiring can cause an electric shock which may be fatal. Ensure the bath is installed by a qualified electrician using current legislation, the equipment must only be connected to a supply main with protective earth.



WARNING RISK OF ELECTRIC SHOCK: This product is powered with 240V AC. Only qualified electricians should work on this product in line with the current legislation. **ALWAYS** disconnect the power supply before removing any panels for maintenance and or repair.



WARNING RISK OF SLIPPING: Water left on the floor could cause serious injury or be fatal by slipping. Ensure the floor area around the bath is always free from water. Clean and dry **ANY** spillages immediately.

HEALTH AND SAFETY CAUTIONS

The following cautions and any additional cautions used throughout this manual **MUST** be observed to avoid damage to your bath or additional optional equipment.



CAUTION: Bath could be damaged which may be irreparable if objects/equipment is trapped during operation. Ensure there are no objects/equipment left under the bath or platform that can become trapped.



CAUTION: Remote handset could be damaged which may be irreparable. Ensure the remote handset is **ALWAYS** returned to its holder after use.



CAUTION: Bath/equipment could be damaged which may be irreparable. **NEVER** use the bath other than for its intended use.



CAUTION: Bath/equipment could be damaged which may be irreparable if using abrasive cleaners, bleach or scouring. Use cleaning methods outlines in the cleaning and maintenance section only.

HEALTH AND SAFETY NOTES

The following notes and any additional notes used throughout this manual contain important information and useful tips on the operation of this product.



NOTE: The system batteries must be charged for 24 hours prior to using the bath. You may test the bath seat operation empty to ensure it is working correctly.



NOTE: If this unit is to be utilised by many different bathers, we would strongly recommend that it is cleaned regularly with a medical disinfectant as well as following the strict cleaning routine outlined in the 'Maintenance and Cleaning' section.



NOTE: In the event of mains failure during use of the bath, back-up batteries will enable the bather to use the bath seat once. The bath seat will then be disabled until mains power is restored.



NOTE: If any serious incident occurs in relation to the device this should be reported to the manufacturer and the competent authority in which the user and/or patient is established.



NOTE: Expected lifetime of this product is 8 years, when adhering to our service and maintenance guidelines.

LABELS

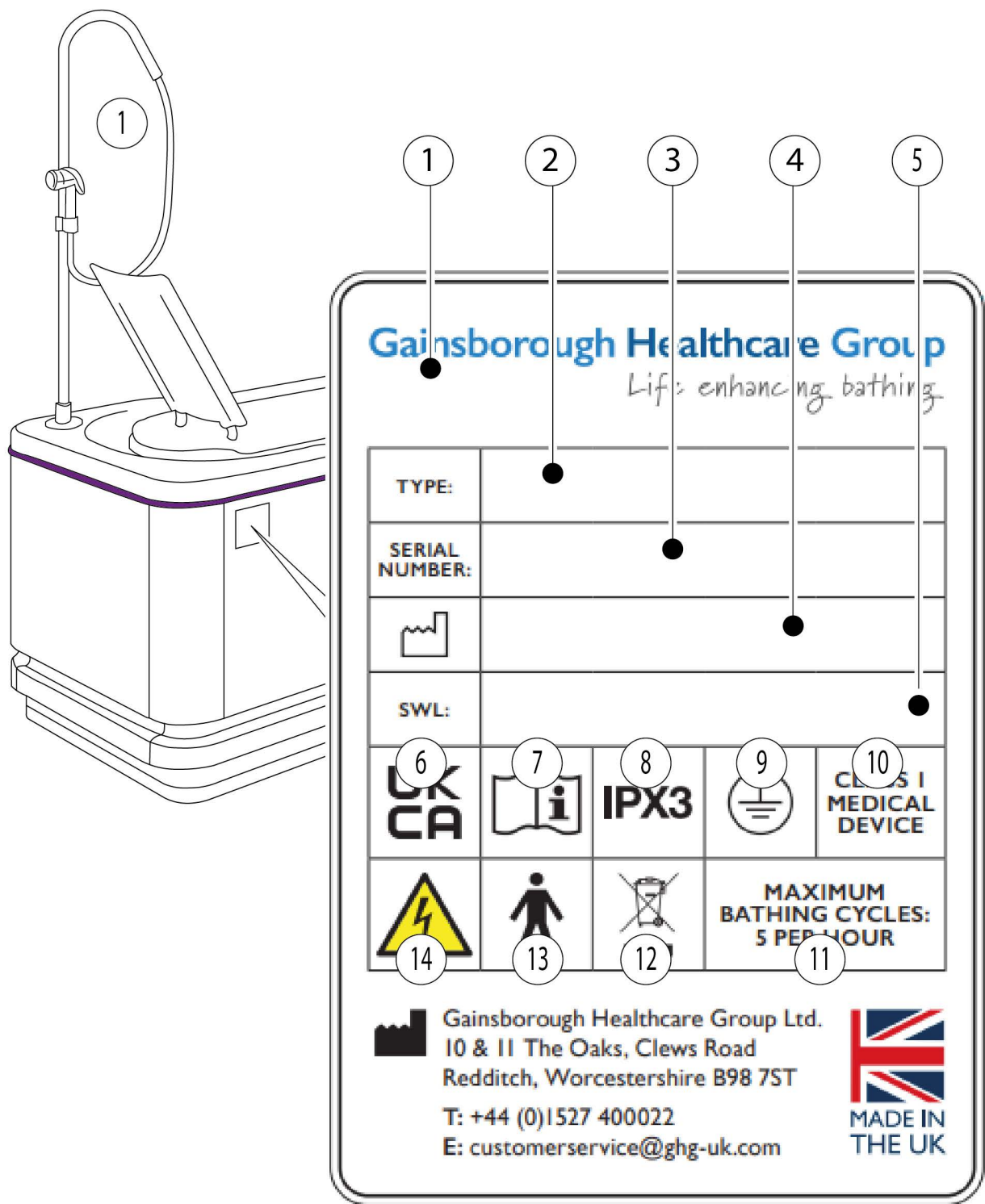

Fig 0320

IDENTIFICATION LABEL



NOTE: The 'Identification' label attached to your bath contains critical information! **DO NOT** remove it from its location. The serial number is required for maintenance, information or spare parts. It is recommended that you make a note of this below.

KEY (Refer to Fig 0320)

- 1 Identification label and its location
- 2 Type of bath this user manual refers to
- 3 Unique identification number (this is needed for maintenance, information or spares)

Make a note below Serial Number:

Serial Number:

- 4 Location where the bath was manufactured
- 5 The Safe Working Load
- 6 UK Conformity Assessed marking
- 7 Read instruction manuals and accompanying documents
- 8 Protection Class (This product is protected against spraying water)
- 9 Type of protection: Class I
- 10 Class I medical device
- 11 Maximum number of baths allowed per hour
- 12 No domestic waste. Separate electrical and electronic components for recycling in accordance with European Directive 2012/19/EU (WEEE)
- 13 Application part 'Type B' according to DIN EN 60601-1
- 14 This product is powered. Warning dangerous voltage

USER INFORMATION

The following steps are a pre-requisite before using the bath in **ANY** capacity.

1. Read the entire user manual.
2. Ensure you have received appropriate training in its safe and proper use for the bath and any additional optional equipment (this should be done following installation hand over).
3. Ensure the bath back up batteries have been fully charged for a minimum of 24 hrs prior to use.
4. Inspect the bath for any cracks or damage.
5. Test the bath and all safety devices/equipment (empty - without a bather) prior to its first use and periodically afterwards in line with the maintenance recommendations, see, [maintenance and cleaning page, 29](#). Ensure it operates correctly as follows:
6. Operate the 'Bath up' function, ensure the bath rises to its maximum height, without excessive or unusual noises.
7. Operate the 'Bath down' function, ensure the bath lowers to the floor, without excessive or unusual noises.



Contact: If you are in any doubt or you cannot answer yes to **ALL**, the above steps then seek advice from your supervisor and or contact Gainsborough Healthcare Group Ltd: Tel: 01527 400022.

REMOTE HANDSET



CAUTION: Remote handset could be damaged which may be irreparable. Ensure the remote handset is **ALWAYS** returned to its holder after use.

Refer to Fig 0034, the 'Remote Handset' (5) comprises of two control buttons. To activate the operation, press the relevant button lightly and hold. Releasing the button/s at any time will stop the operation.

1. LED Illuminates indicates power is supplied.
2. LED flashes when mains power is lost.
3. Bath Up
4. Bath Down
5. Handset

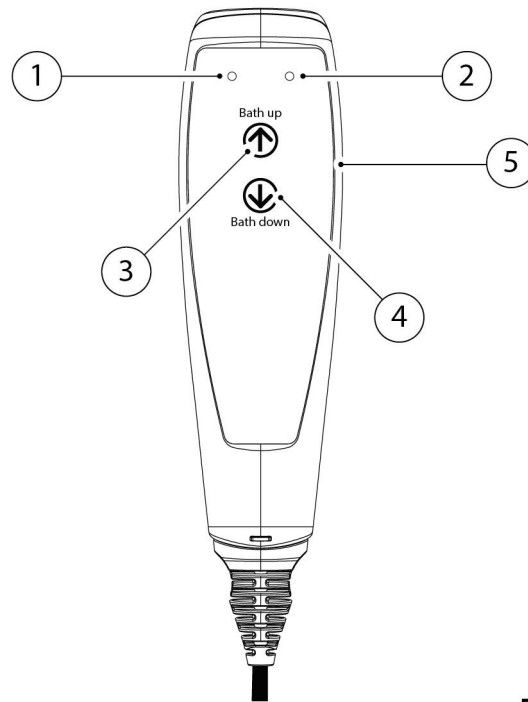

Fig 0034

BACKREST INSTALL

1. Refer to Fig 0245, install the back rest into the platform in the holes provided, the opposite end to the taps. This comes as standard with a slip-resistant cover.

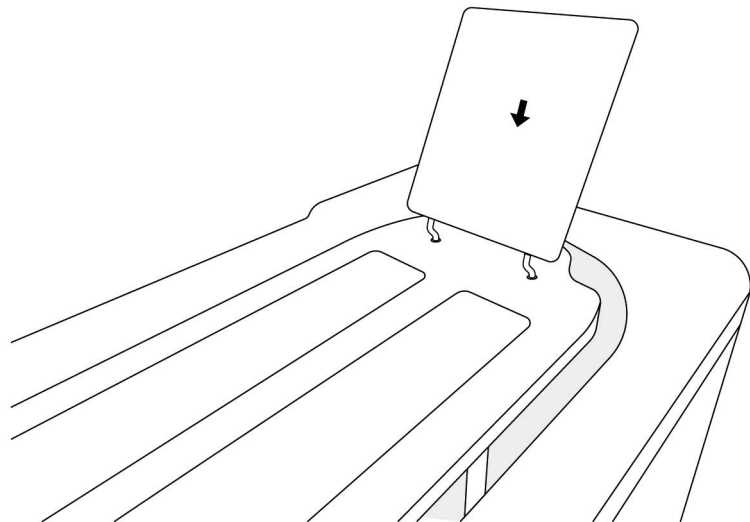

Fig 0245

FOOTREST INSTALL (OPTION)

1. Refer to Fig 0268, install the foot rest into the platform in the holes provided.

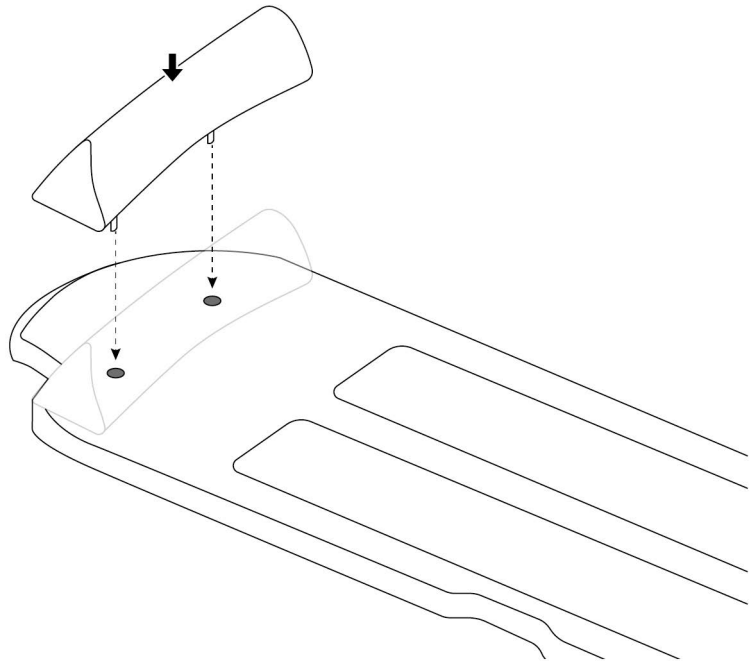

Fig 0268

CLOSE THE POP-UP WASTE

Your bath comes with a pop-up waste as standard.

1. Refer to Fig 0196, close the pop-up waste, turn the chrome handle (1) clockwise, the waste plug (2) closes.

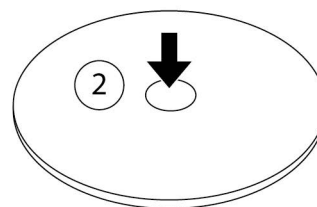
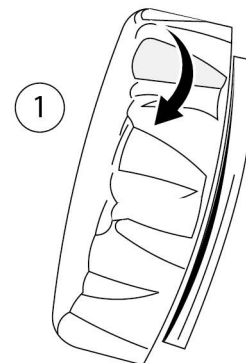

Fig 0196

FILL THE BATH



WARNING RISK OF SCALDING: Not checking the water temperature could cause serious injury or be fatal. The temperature of the hot water is limited to 43°C for safety. Use a thermometer to observe the temperature whilst filling and again before transferring the bather into the bath.

2. Refer to Fig 0307, depending on the options chosen you may have a 'Thermostatic twin lever bath filler' (1) see, [thermostatic twin lever bath filler option page, 25](#) for more information or an 'Autofill' option (2) see, [autofill option page, 24](#) for more information, proceed as follows

3. Open the Hot tap (3) or press the Hot 'Autofill' button (3) and fill the bath to half full at the required temperature checking with a thermometer. Where necessary adjust the temperature using the Cold tap (4) or the 'Autofill' button (4). The bath is now ready for the bather. Topping up of the bath will be carried out when the bather is in position. This aids the carer to observe the depth of water.

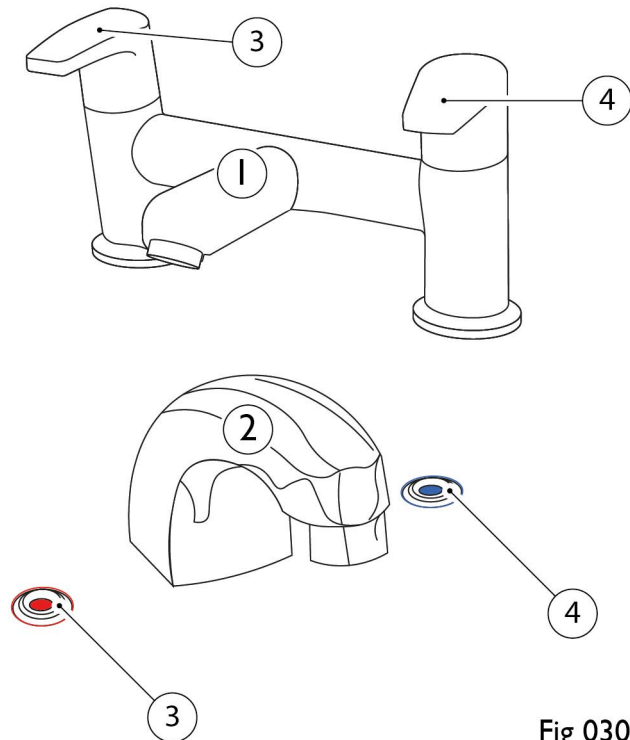

Fig 0307

TRANSFER BATHER INTO BATH



WARNING RISK OF ENTRAPMENT: Operating this bath/equipment when the bather is unsecured/unattended could cause serious injury or be fatal by entrapment. Ensure the bather is **NOT** left unattended and is seated properly at all times.

4. Refer to Fig 0309, allow/assist the bather to transfer onto the platform (a lateral transfer for an ambulant bather).

5. If a lateral transfer is not suitable use appropriate equipment to hoist or transfer the bather into position, refer to the relevant equipment user manual to transfer the bather onto the platform.

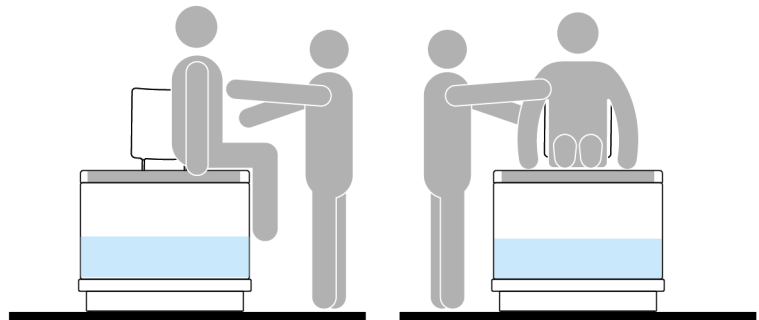

Fig 0309

6. Refer to Fig 0310, with the bather seated, raise the bath around the platform/bather, press and hold the 'Bath up' button (1), adjust to a comfortable height for the carer. The bather will now be immersed in water. To up bath as follows.

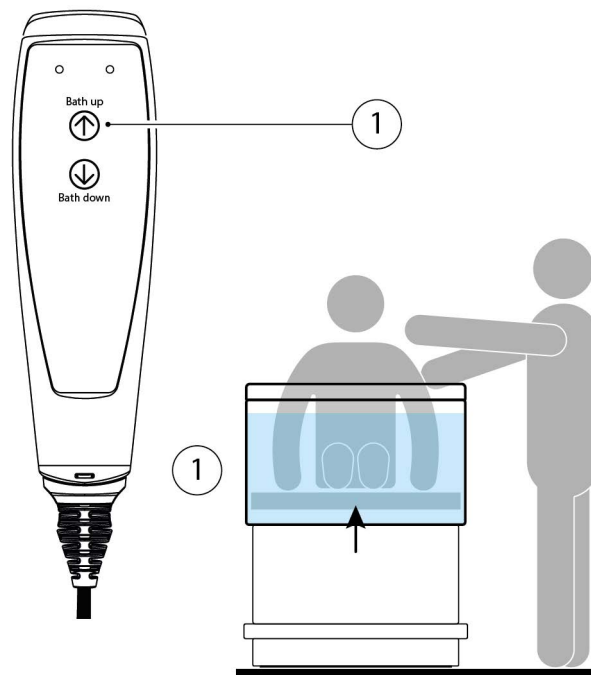

Fig 0310

TOPPING UP THE BATH

7. Refer to Fig 0307, depending on the options chosen you may have a 'Thermostatic twin lever bath filler' (1) see, [thermostatic twin lever bath filler option page, 25](#) for more information or an 'Autofill' option (2) see, [autofill option page, 24](#) for more information, proceed as follows:

8. Open the Hot tap (3) or press the Hot 'Autofill' button (3) and top up the bath checking the temperature with a thermometer. Where necessary adjust the temperature using the Cold tap (4) or the 'Autofill' button (4).

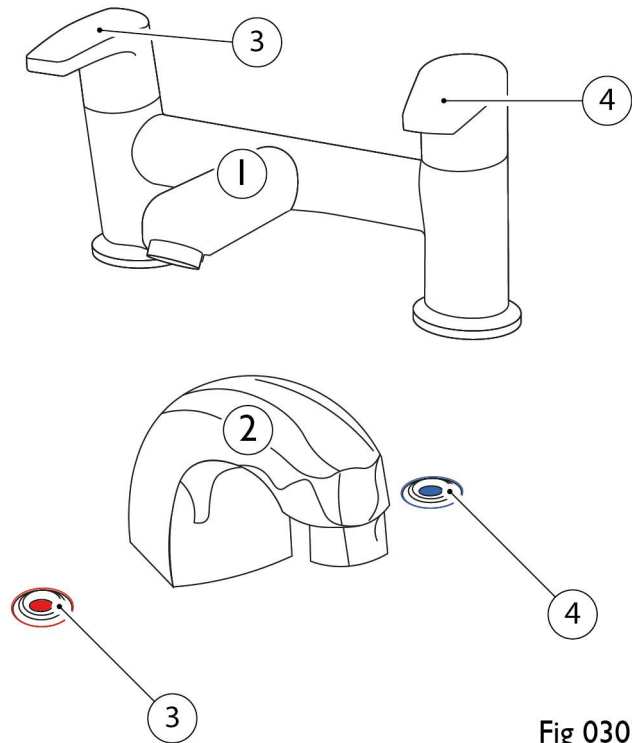

Fig 0307

REMOVE BATHER FROM THE BATH

9. When bathing is completed. Refer to Fig 0311, lower bath full of water, press and hold 'Bath down' button (1) to the lowest position in readiness for transferring the bather.

10. Use the platform for drying/dressing prior to transfer.

11. Allow/assist the bather to transfer off the platform (a bed type transfer for an ambulant bather).

12. If the bather is not able and bather transfer is required, refer to the relevant equipment user manual to transfer the bather from the platform.

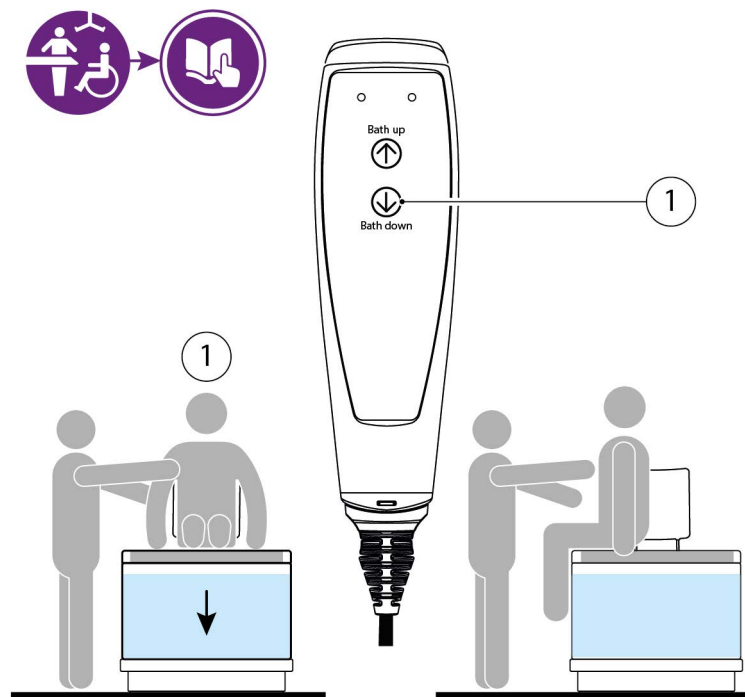

Fig 0311

EMPTY THE BATH

Your bath comes with a pop-up waste as standard.

13. Refer to Fig 0263, open the pop-up waste, turn the chrome handle (1) anti clockwise, the waste plug (2) opens to drain the bath.

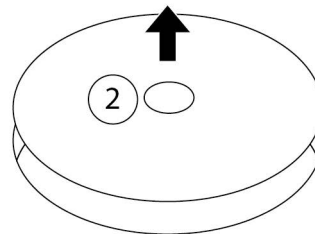
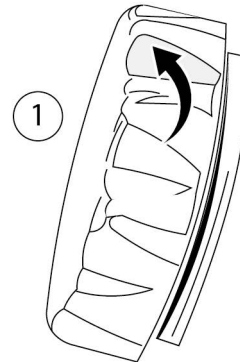

Fig 0263

14. Remove the 'Backrest' and 'Footrest' (option) from the platform and store in a safe place.

15. Thoroughly clean and disinfect the platform and bath see, [maintenance and cleaning page, 29](#) for additional information.

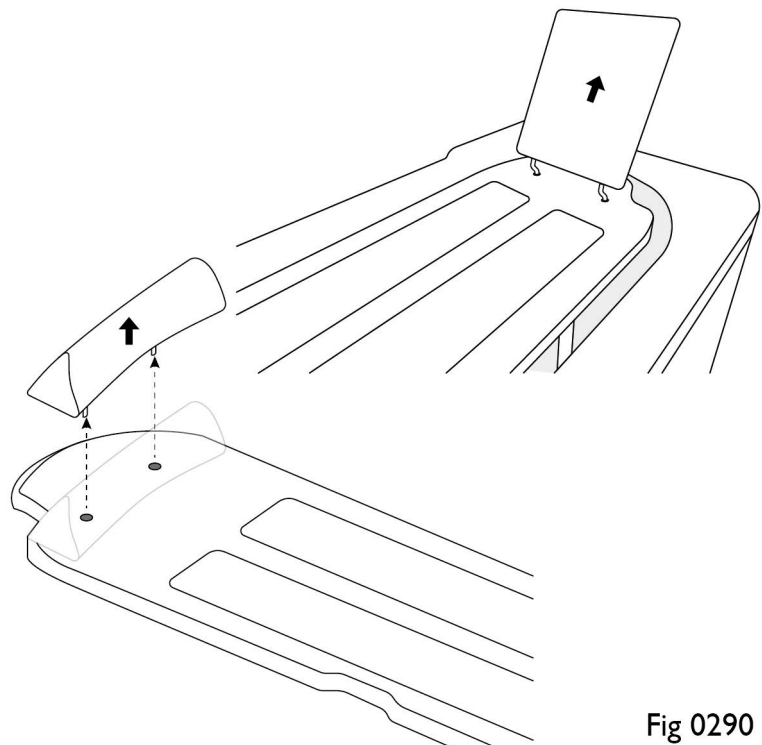

Fig 0290

RAISE THE PLATFORM



CAUTION: Platform backrest/footrest could become damaged which may be irreparable if left on the platform. Remove backrest and footrest before raising the platform.

16. Refer to Fig 0313, locate the safety lock plunger under the platform on the front left, when facing the bath.

17. Using your forefinger and middle finger pull the safety lock plunger (1) toward you, then raise the platform (2).

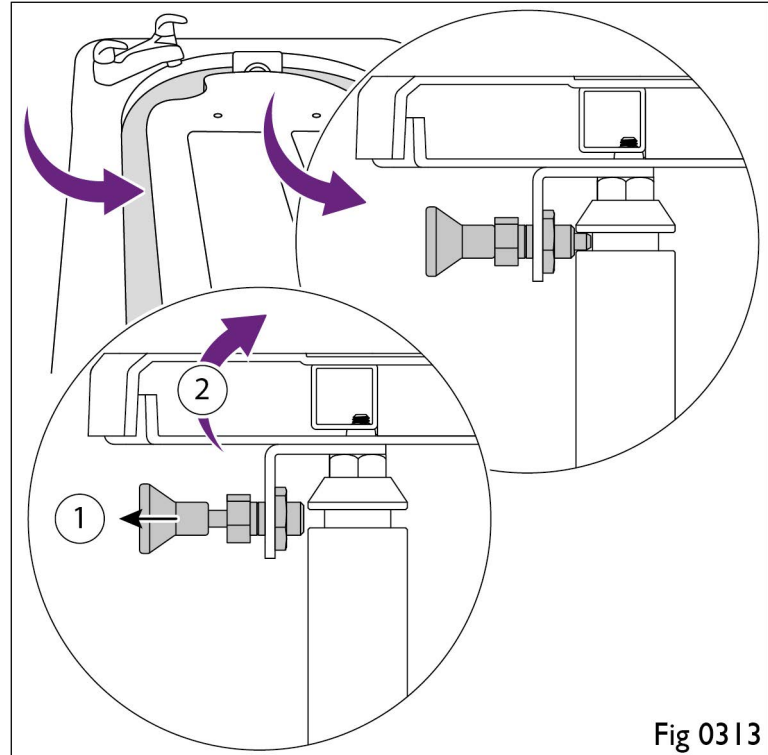

Fig 0313

LOCK THE PLATFORM

18. Raise the platform to its highest position which opens up the 'Hinge stay' to its full extent (1), then slightly lower the platform (2) to engage the 'Hinge stay' locking mechanism.

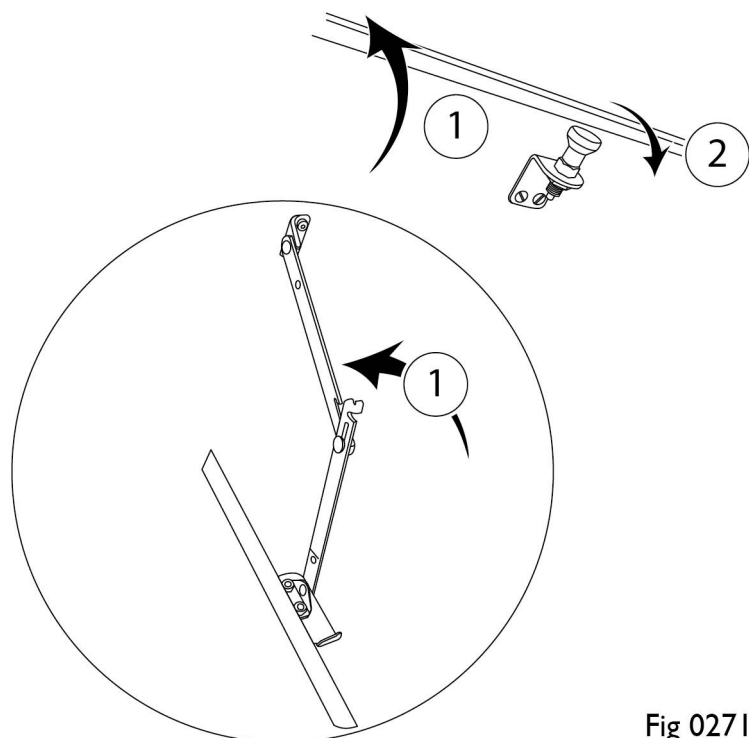

Fig 0271

LOWER THE PLATFORM

19. Refer to Fig 0312, slightly raise the platform and simultaneously bend the 'Hinge stay' (1) to disengage the lock.
20. Lower the platform and gently push with some downward pressure to engage the safety lock plunger (2).
21. Gently pull the platform upward (3) to ensure the safety lock plunger (2) is fully engaged.

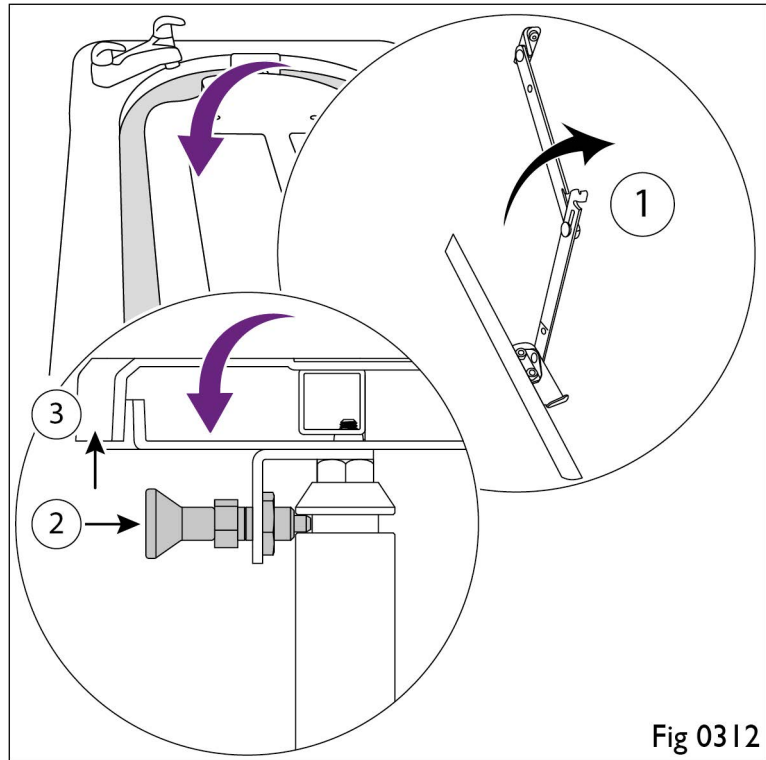

Fig 0312

USING THE SHOWER

The shower system is very simple to operate as follows:

1. Refer to Fig 0020, remove the shower head (1) from the holder, turn the shower control (2) anticlockwise fully. The temperature on the shower valve is controlled by a thermostatic valve and factory set at 38°C for safety.
2. With the shower head (1) directed into the bath press the trigger spray (3) on the shower head (1) to release the water. Check the temperature is safe with a thermometer and by hand. Release the trigger at any time to stop the water.

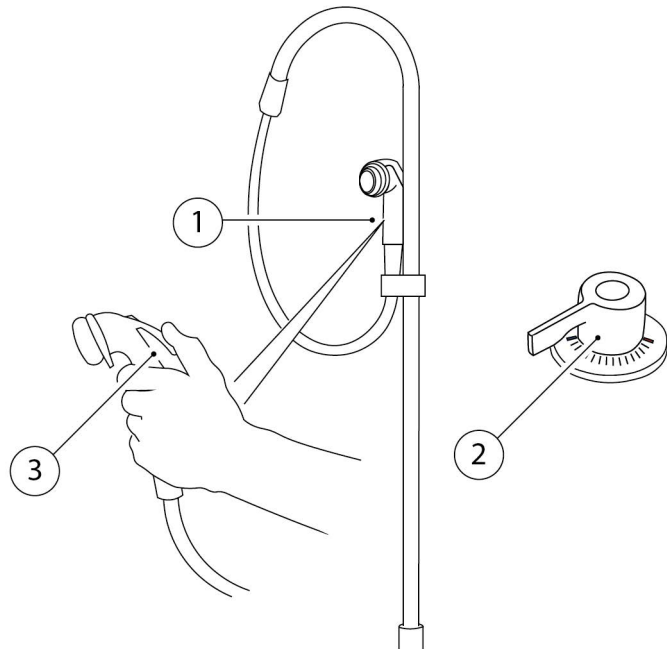

Fig 0020

SHOWER DEPRESSURISE

3. When showering is complete, turn shower control (2) clockwise fully.
4. Pressing the trigger spray (3) to depressurize the shower and return shower head (1) to the holder.

OPTIONAL EQUIPMENT

FOOT REST OPTION

A footrest is available as an option for more information see, [footrest install \(option\) page, 17](#).

AUTOFILL OPTION



NOTE: The auto-fill buttons glow red (hot) and cold (blue) constantly until pressed and will flash during filling.



NOTE: The auto-fill option has a pre-set temperature of 43° degrees Celsius.

The 'Autofill' option allows the bath to be filled with the press of a button using the following procedure:

Hot Water

1. Refer to Fig 0015, the 'Autofill' option has a spout (1). Press the hot (red) button (2) once. The water flow can be stopped at any time by pressing the button again.
2. To add more hot water, press the hot (red) (2) button again. Do not leave the bath unattended if the button is pressed a second time. Check the water temperature with a thermometer.

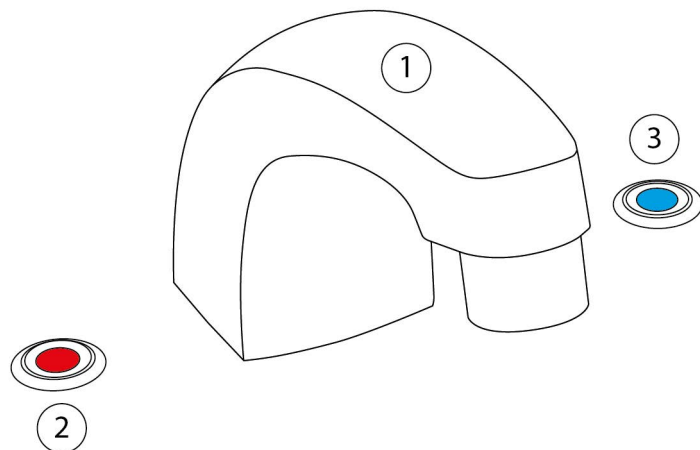

Cold Water

3. To reduce the temperature of the water, press the cold (blue) button (3). The water flow can be stopped at any time by pressing the button again. Do not leave the bath unattended if the button is pressed a second time. Check the water temperature with a thermometer.

Fig 0246

Tamperproof Lockout

4. The 'Autofill' has a lock out to prevent wastage of water and tampering: To Lock: Press and hold down both the hot (red) button (2) and the cold blue button (3) for 10 seconds. The buttons will turn green confirming water lock out.
5. To Unlock: Press and hold down both the hot (red) button (2) and the cold blue button (3) for 10 seconds again. The buttons will turn red and blue confirming unlock.

THERMOSTATIC TWIN LEVER BATH FILLER OPTION



NOTE: The thermostatic twin lever bath filler option has a pre-set temperature of 43° degrees Celsius.

Refer to Fig 0308, the thermostatic twin lever bath filler option is very simple to operate as follows:

1. The mixer spout (1) sits between the two taps.
2. To open the hot tap, turn the handle (2), clockwise. To close the hot tap, turn the handle (2), anticlockwise.
3. To open the cold tap, turn the handle (3), anticlockwise. To close the cold tap, turn the handle (3), clockwise.

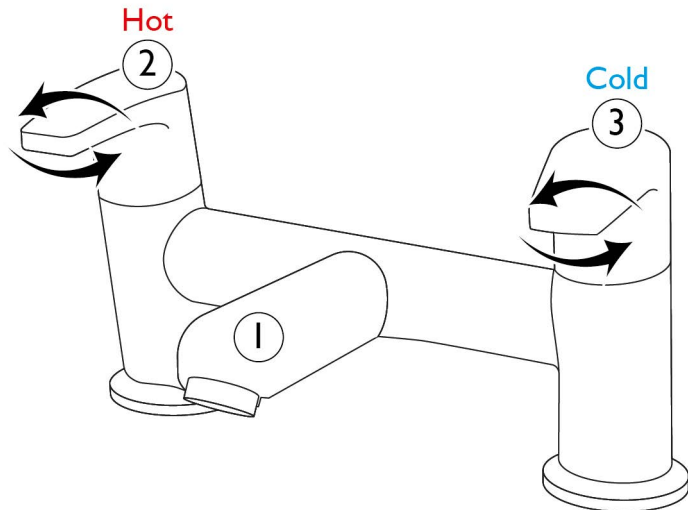

Fig 0308

SCHUCHMANN BASTI SEAT OPTION

The 'Schuchmann Basti Seat' is a seat that can be mounted onto the bath platform and is intended for smaller bathers up to 45Kg. There are two different size 'Schuchmann Basti Seats' available. There is a choice of cover, standard or hollow for pelvis, allowing the bather to seat further down in the seat. An additional retainer strap and head guide are also available. The Basti seat must be used in conjunction with a 'Basti Seat Fixing Bracket', please see user/part manual. A 'Schuchmann Basti Seat and Fixing Bracket User/Parts Manual' is available. For additional information contact Gainsborough Healthcare Group: Tel 01527 400022.

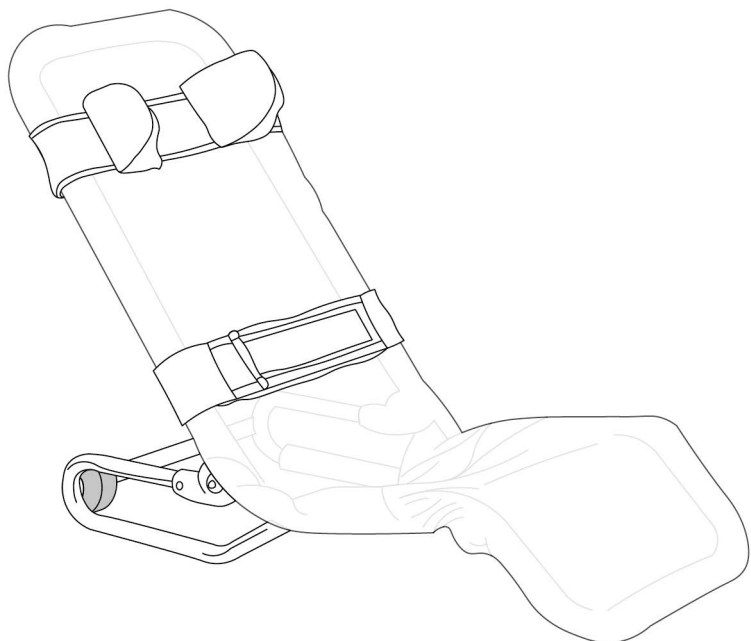

Fig 0275

AIR SPA OPTION

Ensure the bath is full of water, the air spa operates as follows:

1. Refer to Fig 0079, to switch on, press the air spa button (1) once.
2. To vary the speed, press the plus button (2) to increase or the minus button (3) to decrease.
3. Press and hold the air spa button (1) whilst it's on and the spa pulses on then off continuously.
4. To switch off, press the air spa button (1) once again.

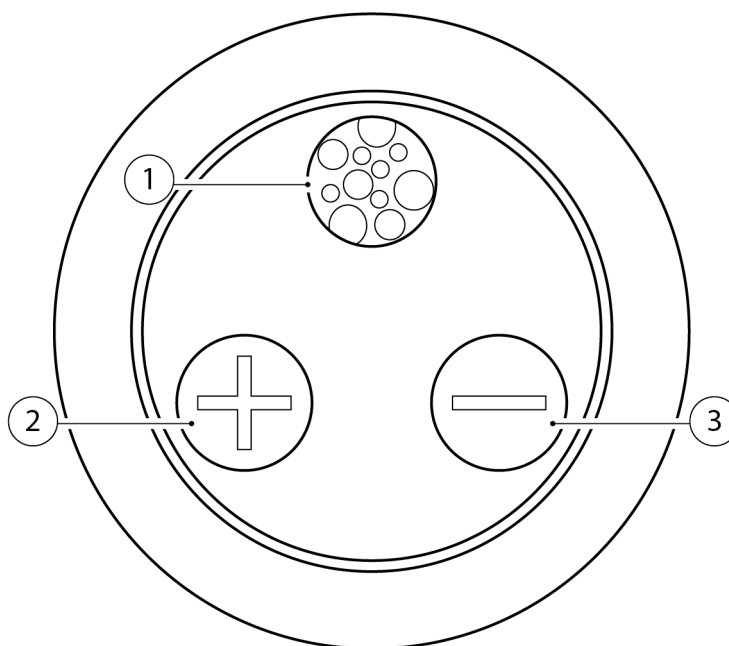

Fig 0079

AIR SPA AND CHROMATHERAPY LIGHTING OPTION

Ensure the bath is full of water, operation is as follows:

Air Spa:

1. Refer to Fig 0078, to switch on, press the air spa button (1) once.
2. To vary the speed, press the plus button (2) to increase or the minus button (3) to decrease.
3. Press and hold the air spa button (1) whilst it's on and the spa pulses on then off continuously.
4. To switch off, press the air spa button (1) once again.

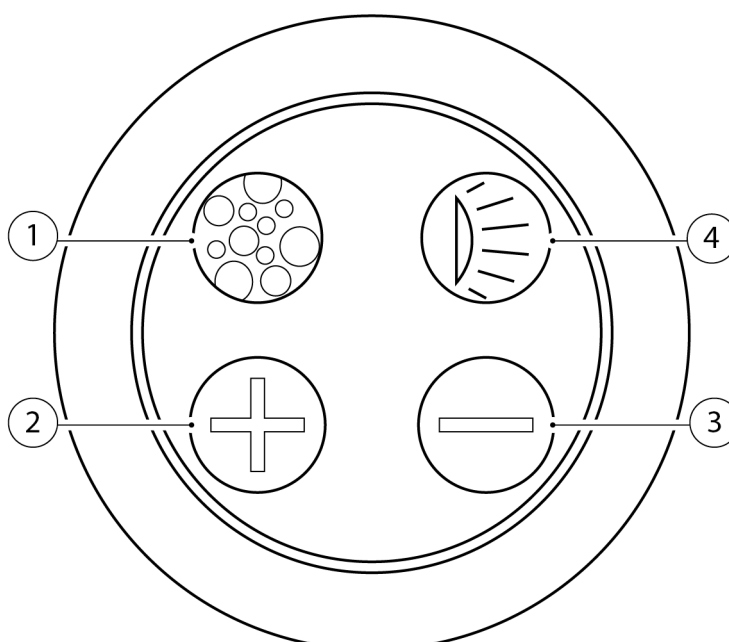

Fig 0078

Chromatherapy Lighting:

1. To switch on press the chromatherapy lighting button (4) once, the lighting cycles from one colour to another colour continuously.
2. To switch off, press the chromatherapy lighting button (4) once again.

CHROMATHERAPY LIGHTING OPTION

Ensure the bath is full of water, the chromatherapy lighting operates as follows:

1. Refer to Fig 0077, briefly press the button (1) once, the lighting cycles from one colour to another colour continuously.
2. If a single, preferred colour, is desired press and hold the button (1) again whilst the colours are cycling, for a few seconds when the desired colour is on. The desired colour will illuminate permanently.
3. To switch the chromatherapy lighting off briefly press the button (1) once whilst the lighting is on.

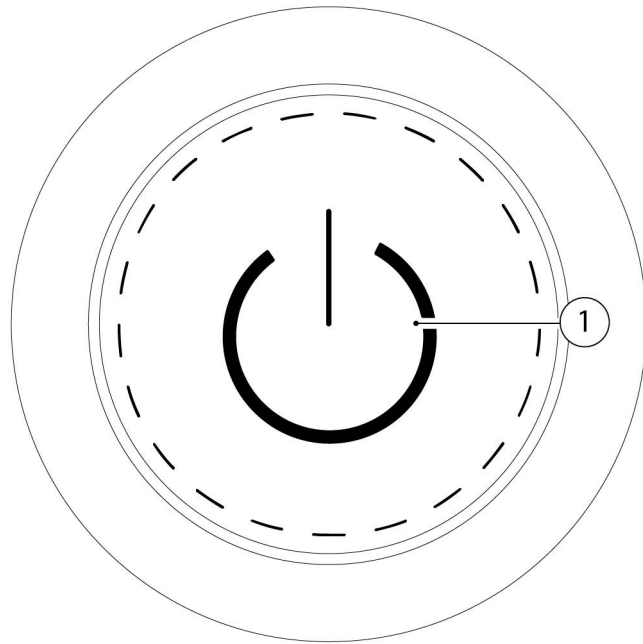

Fig 0077

SOUND SYSTEM OPTION



NOTE: To use the sound system with a smart phone or tablet device for the first time it will be necessary to pair them with blue tooth.

Pairing: New device (first use)

1. Ensure the bath is full of water, on your portable device, smart phone or tablet, ensure Bluetooth is enabled and your device is visible.

2. Refer to Fig 0068, press and hold the Bluetooth button (1) for approximately 5 seconds, a blue LED will illuminate.

3. After approximately 15 seconds, the device enters pairing mode, this is indicated by the blue LED flashing.

4. On your portable device, smart phone or tablet search for available devices.

5. A new device 'SOUNDBOX' will be found.

6. Click on 'SOUNDBOX' to confirm pairing.

7. You may be asked to enter a code, if so, enter the four-digit code 0000.

8. Next, press the Bluetooth button (1) once, this pairs the device, ready for use.

9. If unsuccessful, turn off the devices and repeat the above process.

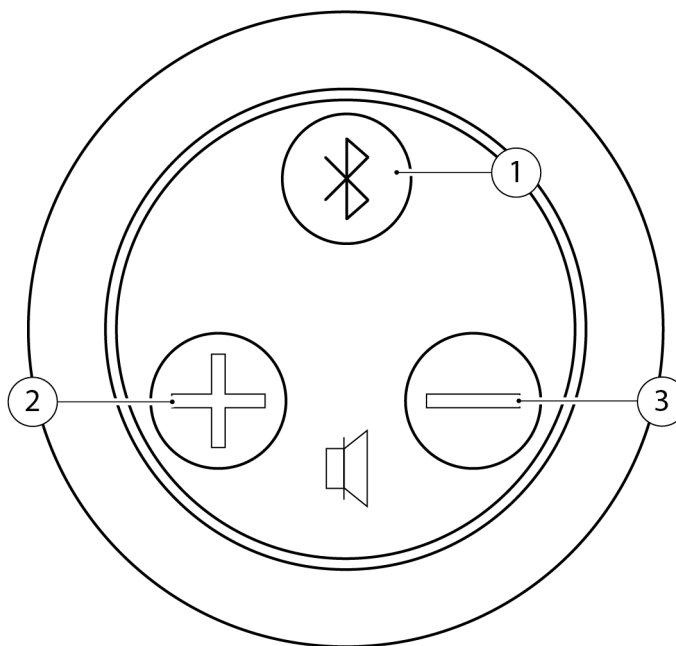

Fig 0068

The sound system operates as follows: once paired

1. Refer to Fig 0068, press Bluetooth button (1).

2. The LED will flash slowly indicating it is ready to use.

3. Your portable device, if already paired will connect automatically. If not ensure it is paired.

4. Increase the volume using the + button (2) or decrease the volume using the - button (3).

5. To turn off press the Bluetooth button (1), the audio device will enter standby mode.

MISCELLANEOUS OPTIONS

There are a multitude of additional options available to improve the bathers experience, such as cushions, postural supports, safety rail, see, [bath and equipment overview page, 4](#). For additional information regarding any optional equipment contact Gainsborough Healthcare Group:

Tel 01527 400022.

MAINTENANCE AND CLEANING



CAUTION: Bath/equipment could become damaged or wear prematurely which may become irreparable ALWAYS carry out thorough and regular cleaning and maintenance. Contact us for clarification/additional assistance if required.



NOTE: Ensure your bath is cleaned/serviced/maintained regularly. Maintenance/cleaning information is provided for maintenance staff employed to look after the bath/equipment supplied.



Contact: Please ask for details of the of Gainsborough Healthcare Group Ltd Service and Maintenance Agreement. Tel 01527 400022.

During cleaning and any maintenance procedures it is of the utmost importance to follow the 'Health and Safety Information' see, [safety information page, 10](#) section, before carrying out any cleaning or maintenance procedures. The following routines are a minimum requirement, where a high volume of use occurs increase the frequency as appropriate.

In addition to the maintenance and cleaning requirements detailed here, it is the responsibility of the equipment operator/provider, under the Provision and Use of Work Equipment Regulations 1998 (PUWER) to ensure, where applicable, that periodic Lifting Operations and Lifting Equipment Regulations (LOLER) testing is undertaken.

DAILY

Routine	Method
Minor clean (after use)	<ul style="list-style-type: none"> Wipe bath whilst draining with a soft damp cloth, clean with disinfectant and wipe dry

WEEKLY

Routine	Method
Major clean (after use)	<ul style="list-style-type: none"> Use cleaning mousse/washing-up liquid/warm water and a soft cloth, stubborn stains may require a non-scratch liquid cleaner, disinfect and wipe dry
Inspect handset/cable	<ul style="list-style-type: none"> Inspect handset and cable for ANY signs of damage
Check water temperature	<ul style="list-style-type: none"> Using a calibrated thermometer operate the hot tap/'Autofill' and check the water temperature it must NOT exceed 43°C
Bath operation	<ul style="list-style-type: none"> Operate bath up and down ensure it operates correctly without obstruction or any undue noise

MONTHLY

Routine	Method
Remove Lyme/Calcium deposits	<ul style="list-style-type: none"> Water stain deposits or minor scratches may be removed using a mild cutting fluid such as 'T' Cut or 'Brasso'
Inspect cables	<ul style="list-style-type: none"> Check there are no loose/damaged/frayed cables
Check for leaks	<ul style="list-style-type: none"> Check water, waste pipes. and all plumbing connections for leaks
Check remote handset operation	<ul style="list-style-type: none"> Operate ALL bath controls 'Bath up' and 'Bath down' ensure all operations are as expected and free from unusual noises see, remote handset page, 15
Test RCD	<ul style="list-style-type: none"> Operate the Residual Circuit Breaker (RCD) press the test button and reset
Inspect shepherds crook shower	<ul style="list-style-type: none"> Ensure the shower pole is fixed/secure and vertical, inspect hose, trigger operation hanger and control see, using the shower page, 23
Test 'Autofill' (option) functionality	<ul style="list-style-type: none"> Test the 'Autofill' operation and water levels see, autofill option page, 24

SIX MONTHLY

Routine	Method
Visual inspection	<ul style="list-style-type: none"> Visually inspect bath ensure there is NO damage
Panel inspection	<ul style="list-style-type: none"> Check all external bath panels are secure with all screws/ fixings in place
Inspect platform fixings and operation	<ul style="list-style-type: none"> Lift the platform see, raise the platform page, 22 and lock in place, see, lock the platform page, 22 inspect fixings and hinges are secure, lower platform and ensure safety plunger locks the platform securely see, lower the platform page, 23
Inspect waste pipes	<ul style="list-style-type: none"> Ensure ALL waste fitting are secure free from leaks and drain efficiently
Inspect all optional safety equipment	<ul style="list-style-type: none"> Inspect any optional safety equipment is free from ANY damage

ANNUALLY

Routine	Method
Servicing	<ul style="list-style-type: none"> Servicing by Gainsborough Healthcare Group Ltd or a trained approved company with guidance

During cleaning and any maintenance procedures it is of the utmost importance to follow the 'Health and Safety Information' refer to the HEALTH AND SAFETY section, before carrying out any cleaning or maintenance procedures. The following is a typical schedule for the average user, where a high volume of use occurs increase the frequency as appropriate.

Maintenance Schedule Minimum Frequency	Day	Week	Month	6 Month	Year
Minor clean (after use)	X				
Major clean (after use)		X			
Inspect handset/cable		X			
Check water temperature		X			
Bath operation		X			
Remove Lyme/Calcium deposits			X		
Inspect cables			X		
Check for leaks			X		
Check remote handset operation			X		
Test RCD			X		
Inspect shepherds crook shower			X		
Test 'Autofill' (option) functionality			X		
Visual inspection				X	
Panel inspection				X	
Inspect platform fixings and operation				X	
Inspect waste pipes				X	
Inspect all optional safety equipment				X	
Servicing					X

TROUBLESHOOTING

The following is a basic troubleshooting guide in the event of failure, it is not intended as a comprehensive diagnostic routine. If the bath or equipment fail to operate as intended following these basis checks, please contact a service support engineer Tel 01527 400022.

PROBLEM	POSSIBLE CAUSE
Bath Inoperative	<ul style="list-style-type: none"> • Mains power supply failure, check handset power supply • Check condition of handset cord and it is securely connected to the bath • Check 5Amp fused spur (fuse) • Check Residual Current Device (RCD) has power and not tripped • Remove platform rods and re-grease with 'Silicone Paste'
Bath Judders	<ul style="list-style-type: none"> • Check there are no obstructions on or around the bath • Check bath fixings are secure • Check bath is level • Remove platform rods and re-grease with 'Silicone Paste'
Bath Noisy	<ul style="list-style-type: none"> • Check there are no obstructions on or around the bath • Check pipework, cables or anything else is not fouling on any panels or framework during operation • Remove platform rods and re-grease with 'Silicone Paste'
Water Leaking/Loss	<ul style="list-style-type: none"> • Visually inspect for bath damage • Inspect flexi-hoses pipework • Inspect hot and cold supply pipework • Inspect waste pipework • Remove platform rods and re-grease with 'Silicone Paste'
Bath Uneven	<ul style="list-style-type: none"> • May occur after a power failure. Attempt a reset, operate handset 'Bath down' button then operate 'Platform down' to lowest position then re-test
Bath Beeping	<ul style="list-style-type: none"> • Mains power supply failure, check handset power supply
Bath Panels touching/fouling/noisy	<ul style="list-style-type: none"> • Inspect remove and refit bath panels to ensure correct fitting and alignment

WARRANTY

If the bath is installed by a 3rd party, we highly recommend that it is commissioned by a **Gainsborough Healthcare Group Ltd** engineer.

Our bath products are guaranteed for a period of twelve months from the date of delivery.

All parts are covered against defects that may arise as the result of faulty materials, inferior workmanship or construction.

The baths are not covered for any problems that may arise from the installation or site planning unless carried out by our installation team from **Gainsborough Healthcare Group Ltd**.

Any consequence arising from unskilled or incorrect handling of the product is not covered by this guarantee.

The following items, when supplied by **Gainsborough Healthcare Group Ltd** are guaranteed for a period of twelve months from the date of supply for the parts only (labour costs are not covered).

- Taps and mixers.
- Shower hoses, shower heads and shower brackets.
- Flexible pipes including waste outlet, hot and cold supply.

Hot and cold taps and mixer taps are proprietary fittings and as such carry a standard manufacturer's warranty.



NOTE: Thermostatic mixing valves must be adjusted for the appropriate discharge temperature by the installer. These require regular maintenance for which **Gainsborough Healthcare Group Ltd** service team is available.

Electrical

All electrical components fitted to Gainsborough Specialist Bathing are CE marked to comply with current Standards.

Electrical items must not be replaced with alternative components without the authorisation of **Gainsborough Healthcare Group Ltd**.

Failure to obtain such authorisation will exempt the company from any liability to action for further failure.

IMPORTANT SAFETY INFORMATION



WARNING RISK OF ELECTROCUTION/FIRE/ENTRAPMENT:

Modifying the bath/equipment could cause serious injury or prove fatal. Under **NO CIRCUMSTANCES** should you modify the bath/equipment.

Your bath supplied by the **Gainsborough Healthcare Group Ltd** is part of a range of products designed and built for care homes, hospitals and other specialist care environments.

Please ensure you read and thoroughly understand this user manual. This information is vital to ensure correct operation and that the bath functions in the intended manner, in the interest of safety always, for both bather and operator.

To ensure best practice and safety the bath must be operated only by a trained professional with adequate understanding of the specific environment, its common practices and processes. It is vital that regular assessments of the bather are undertaken to ensure the bath or product remains suitable. **Gainsborough Healthcare Group Ltd** does not take responsibility for individual product suitability this is the duty of the care facility.

This bath is for hygiene and relaxation purposes only.

Depending on configuration our baths may have sensory features installed. These are for the enjoyment and relaxation of the bather. To ensure these features are used in the correct manner the bather's condition must be assessed prior to operation.

To avoid entrapment, make sure that the path of movement is free from obstacles. Make sure the bather retains a comfortable and safe reclined position. To avoid injury, do not leave the bather at any time. The bather must not dismount the bath whilst the bath sides are raised. This could potentially put the user at risk, causing serious injury as well as damage to the product.

Gainsborough Healthcare Group Ltd does take any liability if misused in this manner.

Gainsborough Healthcare Group Ltd is not responsible for any safety incidents or functional performance issues arising from a result of modifications. If you have any questions regarding the user manual or operation of the bath, contact our support team:



Contact: Gainsborough Healthcare Group: Tel 01527 400022.

There is no other warranty expressed or implied including, but not limited to, those of merchantability and fitness for a particular purpose.

The foregoing warranty is limited to the time specified from the time of receipt. In no event shall the supplier be liable for any special, incidental, punitive, or consequential damages including but not limited to, loss of use.

While this warranty gives you specific legal rights you may also have other rights which this warranty does not exclude you from.

Gainsborough Healthcare Group Ltd operates a policy of continuous product development and reserves the right to change specifications and designs without prior notice.

DECLARATION OF CONFORMITY

Gainsborough Healthcare Group
*Life enhancing bathing.***Certificate of Conformity**

We, Gainsborough Healthcare Group of:
10 & 11 The Oaks
Clews Road
Redditch
Worcestershire
B98 7ST

Declare that:

The Oraya

Conforms to the following Directives:

- 2006/42/EC Machinery Directive
- MDR 2002 – Class 1 Medical Device

and has been designed and manufactured to the relevant parts of the following standards:

- ISO 10535:2006 Hoists for the Transfer of Disabled Persons.
- IEC 60601-1-11:2015 – Medical electrical equipment – Part 1-11: General requirements for basic safety and essential performance – Collateral standard: Requirements for medical electrical systems used in the home healthcare environment.

I hereby declare that the equipment named above has been examined and tested and found to comply with the relevant sections of the above reference specifications. The products comply with all the essential requirements of the Directives.



.....

Peter Eckhardt
C.E.O

16/02/2022

.....

Date

Gainsborough Healthcare Group

Life enhancing bathing



Empowering. Healthcare. Solutions

For service or sales queries please contact:

Tel: 01527 400022

Email: info@gainsboroughbaths.com

10 & 11 Clews Road, Redditch, Worcestershire B98 7ST