

## PRO Comfort Bath – Fixed Height with Leg Lift

Delivering reliable performance and  
functionality for a care home setting.



Optimised for efficiency and performance in multi-user settings the PRO Comfort bath is a fixed height bath with powered seat and leg lift.

The PRO Comfort fixed height with leg lift provides a smooth bather transfer in and out of the bath, negating the need for additional moving and handling.

The unique leg-lift facility offers full leg support throughout the transfer process and also eliminates the need for carers to lift a bather's legs up and over the side of the bath.

Sizes available:

PRO Comfort Bath FH LL available in 1500 and 1700 lengths.

### Key features:

- Powered seat traverse effortlessly transfers the bather in and out of the bath, reducing the need for manual handling
- The 1700mm full length bath boasts extra-long internal bathing length and wide seating area, ensuring optimum comfort for bathers
- The ultra-compact 1500mm bath is perfect for space restricted environments
- TMV3 controls maintain a safe, comfortable, pre-set water temperature, reducing any risk of scalding
- Shepherds crook shower offers CAT5 protection suitable for commercial environments
- Easy clean stainless steel bath seat frame and adjustable nursing arms for client comfort and safety
- Reliable, quiet electronics with integrated battery backup safety system in case of mains power failure
- Ergonomic and intuitive remote handset for easy and simple operation
- Comes as standard with a full height front panel. End panel, Island and Peninsular panel options available
- 165kg (25 stone), safe lifting weight accommodates the majority of bathers
- Left- or right-hand configurations adapt to any bathroom layout



**Gainsborough Healthcare Group**  
*Life enhancing bathing.*

01527 40022

info@gainsboroughbaths.com

www.gainsboroughbaths.com

# PRO Comfort Bath – Fixed Height with Leg Lift

## Technical Drawings

Dimensions in millimetres (mm).

Right-hand example (handing of a bath is indicated by the exit point of the bath when in a seated position).

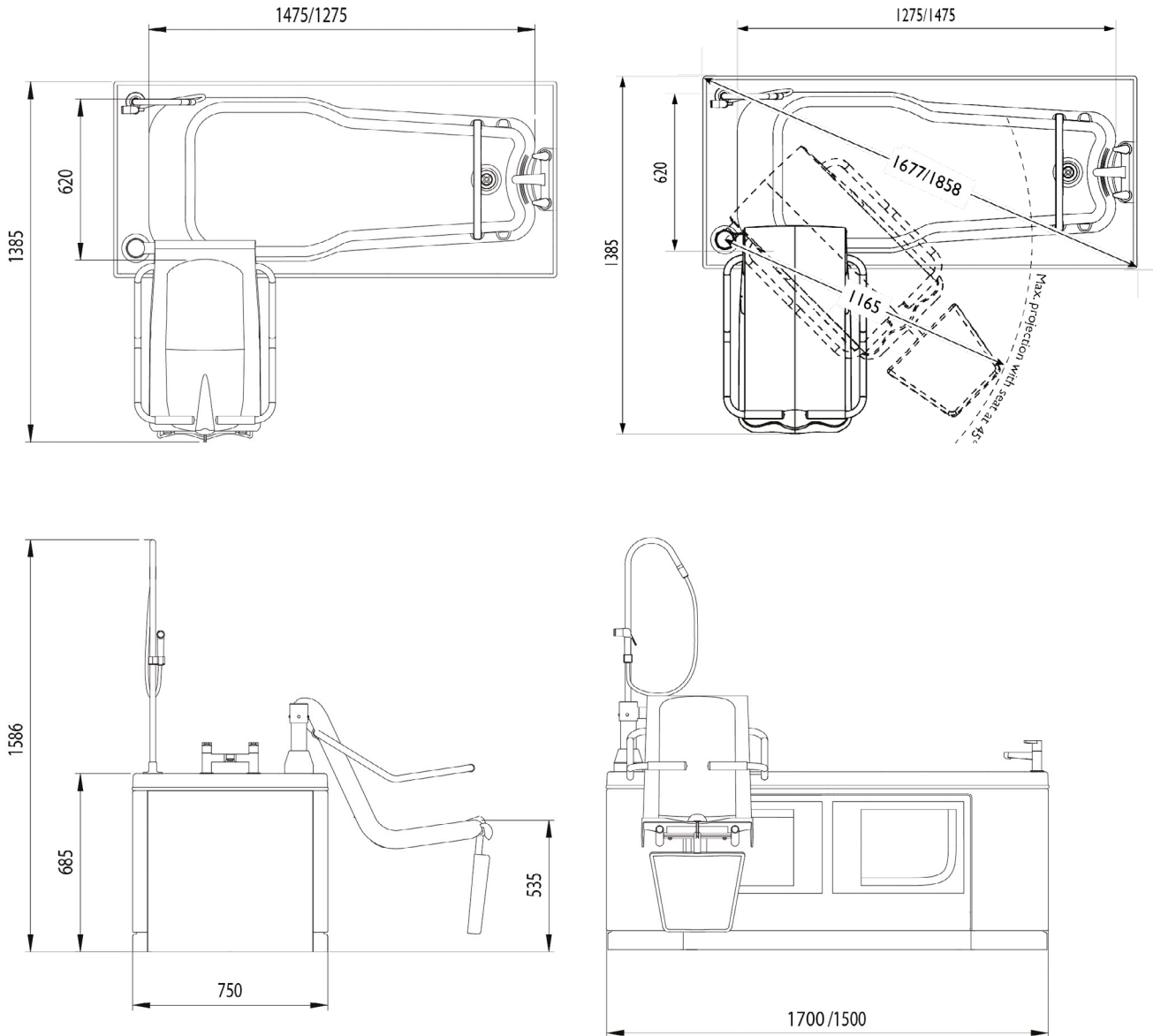

Fig 0025



**Gainsborough Healthcare Group**  
Life enhancing bathing.

01527 40022

info@gainsboroughbaths.com  
www.gainsboroughbaths.com

# PRO Comfort Bath – Fixed Height with Leg Lift

## Technical specification

Length (mm)	1500/1700
Width (mm)	750
Height (mm)	685
Internal depth (mm)	420
Footwell width (mm)	420
Internal width (mm)	605
Internal length (mm)	1275/1475
Seat Base length / width (mm)	460/430
Seat transfer height when down outside bath (mm).	535
Bath height with shower pole 1500 baths only (mm)	1586
Hoist Tunnel - HA panel option 1500/1700 (mm)	130*800 / 130*1000
Maximum user weight	165kg
Water capacity	1500mm - 200 litres 1700mm - 230 litres
Approximate bath weight (empty)	1500mm - 125kg 1700mm - 130kg
Approximate bath weight (full)	1500mm - 325kg 1700mm - 360kg
Typical mechanical operation times	Seat - 266 secs/cycle

Class I Electrical Device	
Power supply	Mains 230V to be supplied via 30mA RCD
Operating voltage	24V
Battery backup	24V DC lead acid, for emergency use only
Actuator duty cycle	Max. 10% or 2min continuous use followed by 18min not in use.  The life cycle test has been performed with a stabilised power supply (10% duty cycle) on a 20mm stroke actuator at max. load for 10,000 cycles at ambient temperature
Water supply	Unblended Hot & Cold water at 1bar Min > 3.5bar Max pressure
IP Rating	IPX3
A' weighted sound emission	<60dB(A)
A' weighted sound emission with air spa system (option)	<75dB(A)
Ambient temperature range	5°C to 50°C
Relative humidity range	10-80%
Atmospheric pressure range	50kPa to 106kPa
Medical Device Category	Class I

### Antimicrobial protection

This bath includes BioCote® technology which has been proven to reduce bacteria and even some viruses, including influenza A H1N1, E.coli, MRSA and Pseudomonas.

### Intended use

This equipment is intended to facilitate the bathing of residents in care facilities or in a home care environment. The product is designed to help people who struggle with getting in and out of a bath, especially those with physical limitations. It's useful for both hygiene and relaxation purposes.

### Caution

To ensure best practice and safety the bath must be operated only by a trained professional with adequate understanding of the specific environment, its common practices and processes. It is vital that regular assessments of the bather are undertaken to ensure the bath remains suitable.

Please be aware of the sound emission and any optional accessories working attributes to ensure bather suitability before operation.

If you have any questions regarding this product or operation of the bath, feel free to contact your authorised representative or Gainsborough Healthcare Group Ltd. on 01527 400022.



**Gainsborough Healthcare Group**  
Life enhancing bathing.

01527 400022

info@gainsboroughbaths.com  
www.gainsboroughbaths.com